

MODELL
HCQ

90 Grad
EINSCHRAUBBOHRUNG: T-17A

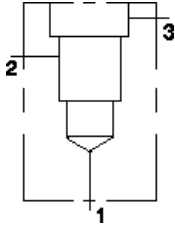

KONFIGURATION ÄNDERN

(none) Modifier 6061-T651
Aluminum, Buna-N

PORT HEADINGS AND SIZES

Model	Port Heading	Size
HCQ	Ports 1 & 2	1 1/4" Code 61
HCQ	Port 3	SAE 6
HCQ/M	Ports 1 & 2	1 1/4" Code 61
HCQ/M	Port 3	1/4" BSPP

BEMERKUNGEN

Important: Carefully consider the maximum system pressure. The pressure rating of the manifold is dependent on the manifold material, with the port type/size a secondary consideration. Manifolds constructed of aluminum are not rated for pressures higher than 3000 psi (210 bar), regardless of the port type/size specified.

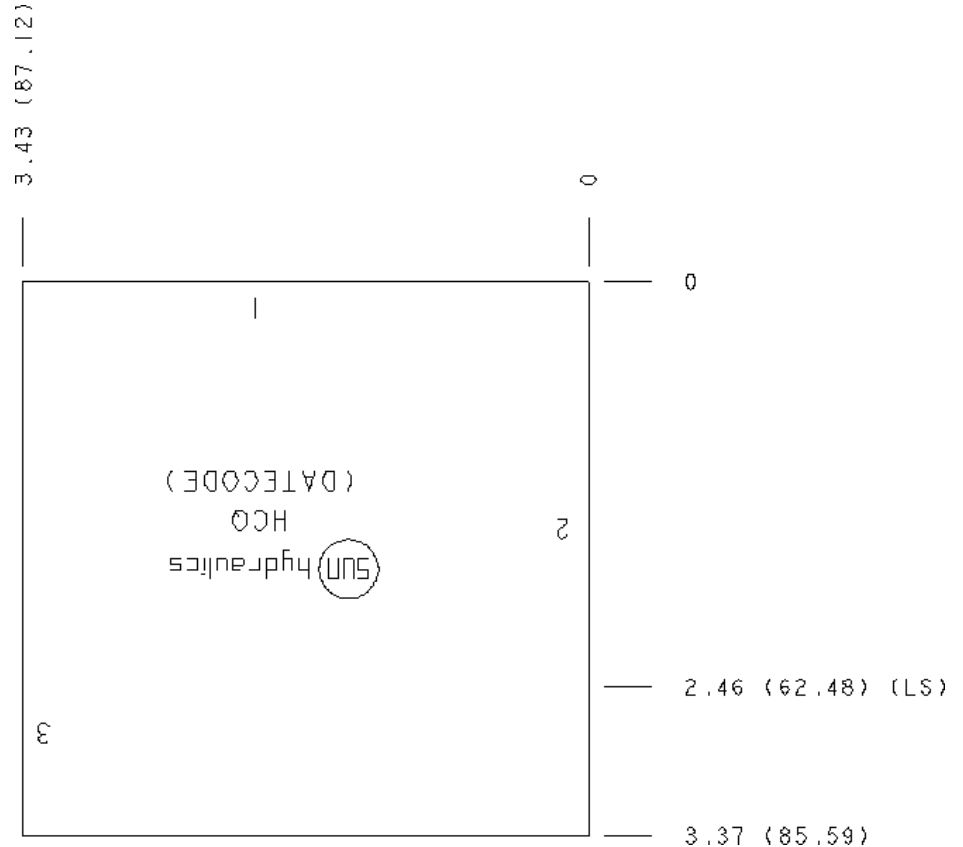

TECHNISCHE DATEN

Gehäusotyp	Rohrleitungseinbau
Lochbild	Kein
Gehäuseeigenschaften	90 Grad
Gewinde der Montagebohrung	.375-16 UNC - 2B in.
Montagebohrungstiefe	15,7 mm
Anzahl der Montagebohrungen	2
Einschraubbohrung	T-17A
Open Cavities	1
Anschlussgröße	SAE 1 1/4" - 3000 psi
Gewicht	1.45 kg.

CONFIGURATION OPTIONS

MODIFIER

		6061-T651 Aluminum, Buna-N
Standard Options	/M	6061-T651 Aluminum, Metric, Buna-N
	/S	65-45-12 Ductile Iron, Buna-N, Blackened
	/T	65-45-12 Ductile Iron, Metric, Buna-N, Blackened

MANIFOLD FACES

FACE GRID

1	2	3	4
5	6	7	8
9	10	11	12

Face 2

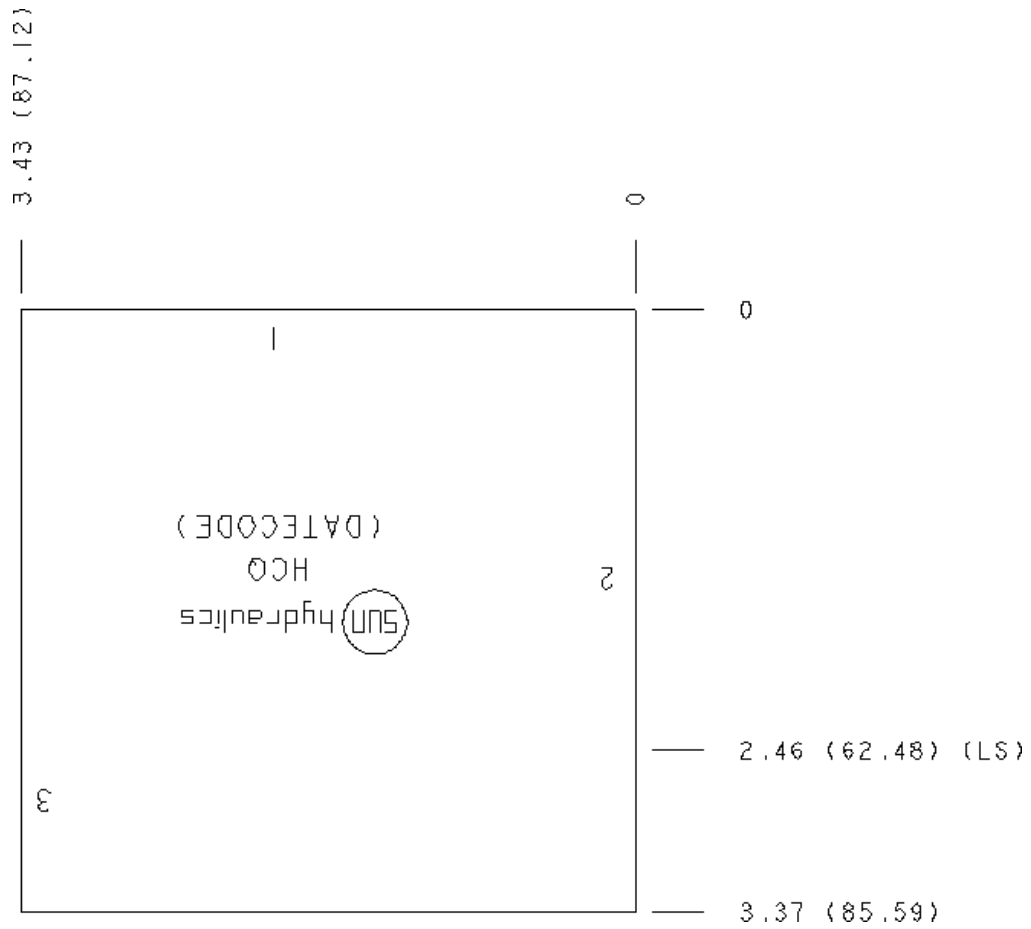

Face 5

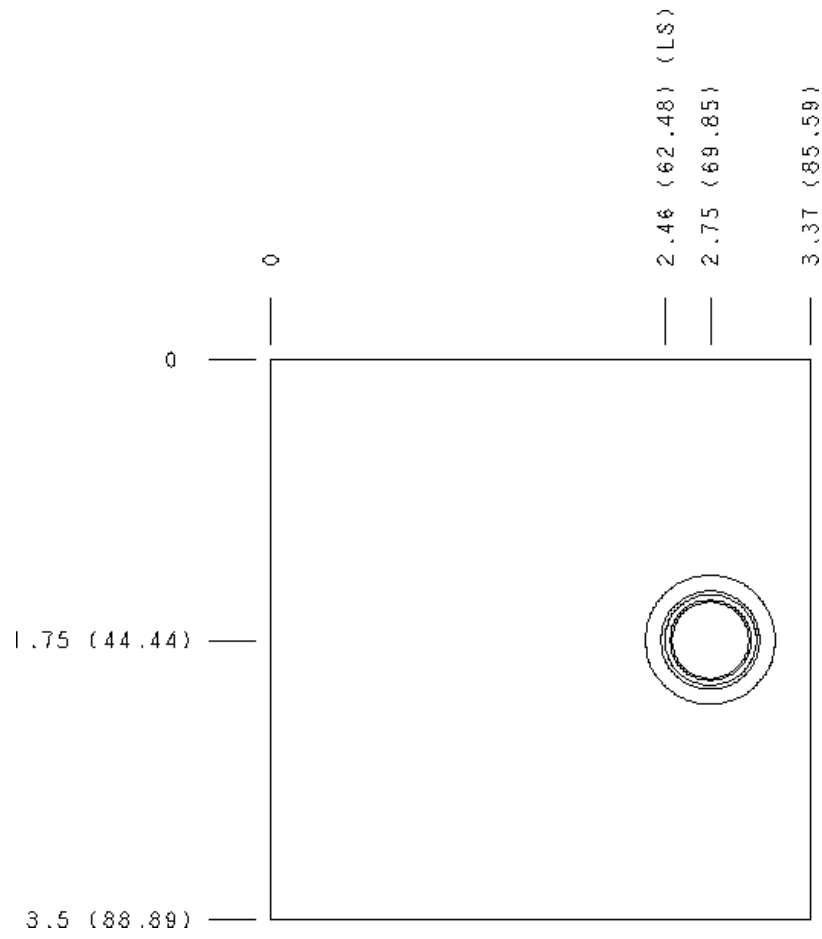

Face 6

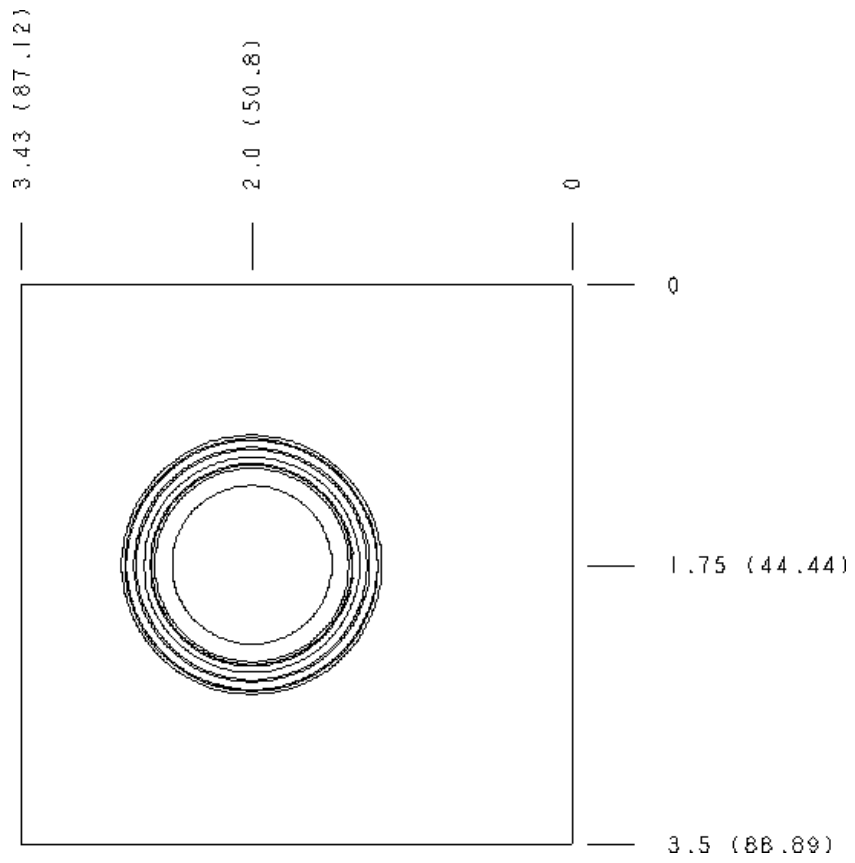

Face 7

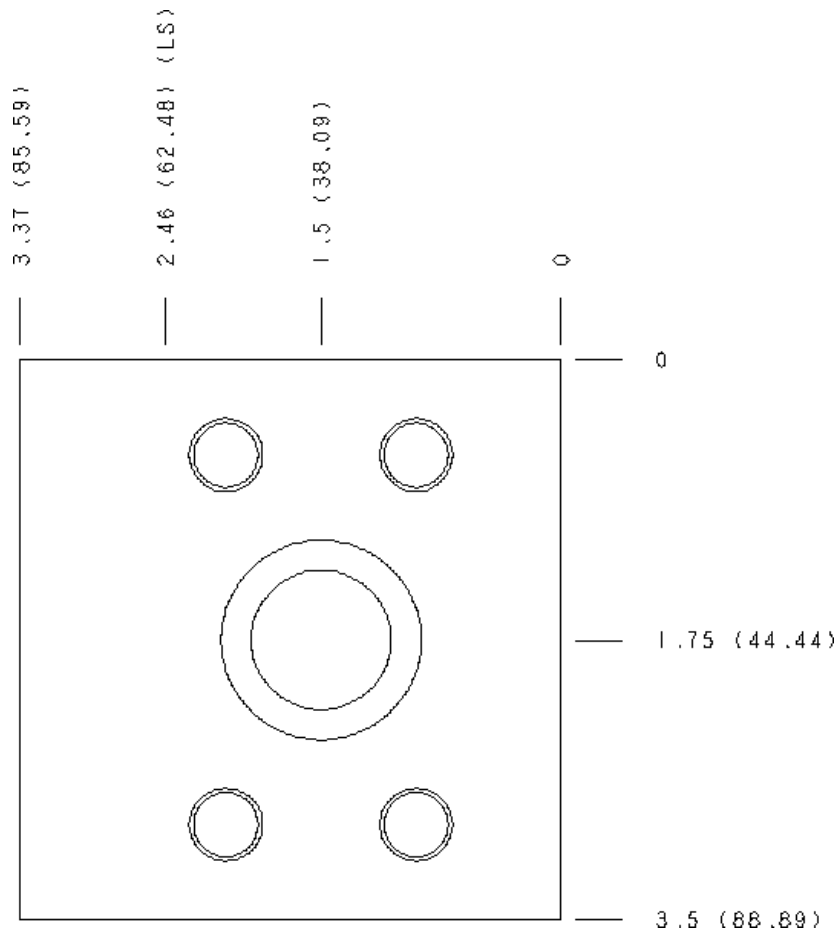

Face 8

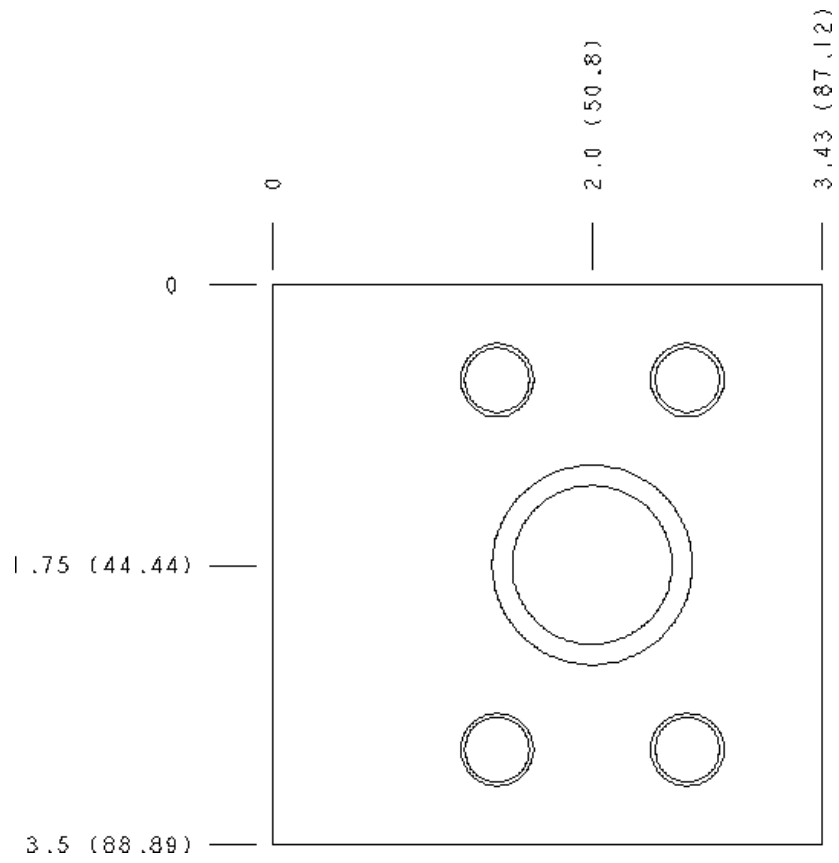

Face 10

